



COMETA



GELATO
Gelato
Gelato
Gelato



PASTICCERIA
Pastry
Pâtisserie
Konditorei



PRALINERIA
Praline
Pralinerie
Pralinen



CALDO A SECCO
Dry Heat
Chaud A Sec
Trockene Wärme



BAGNO MARIA
Bain marie
Bain marie
Wasserbad

Modello di vetrina dalla vasta gamma di servizi: dal gelato alla pasticceria, pralineria e gastronomia. Il design della COMETA rappresenta il carattere giovane e dinamico di Ital Proget.

Display case model offering a wide range of services: from ice-cream to pastries, candies to delicatessens. COMETA design represents the young, dynamic character of Ital Proget.

Modèle de vitrine permettant une vaste gamme de services : de la glace à la pâtisserie, des chocolats à la gastronomie. Le design de COMETA représente le caractère jeune et dynamique d'Ital Proget.

Die vielseitige Vitrine mit verschiedenen Einsatzmöglichkeiten: geeignet für Eisdiele, Konditorei, Konfiserie und Gastronomie. Das Design von COMETA verkörpert den jungen und dynamischen Geist von Ital Proget.





GELATO
 Gelato
 Gelato
 Gelato



PRALINERIA
 Praline
 Pralinerie
 Pralinen



PASTICCERIA
 Pastry
 Pâtisserie
 Konditorei



GELATO
Gelato
Gelato
Gelato



SINGLE AIR FLOW



-16 / -18 °C



7 (35°C - 75%UR)

H=1220

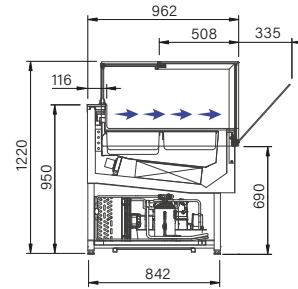
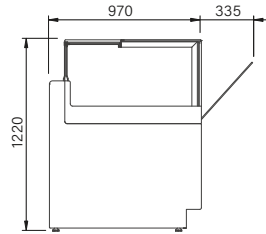

H=1380

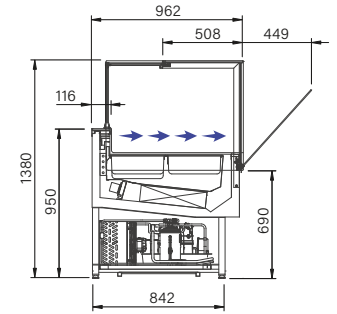
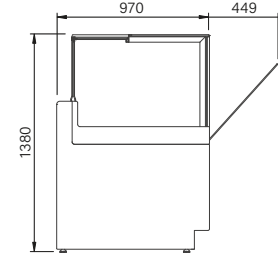

12

Con vaschette **STANDARD**: 5Lt - 7Lt

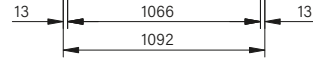
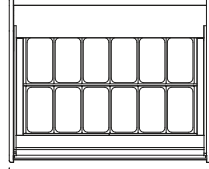

18

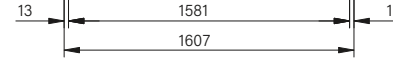
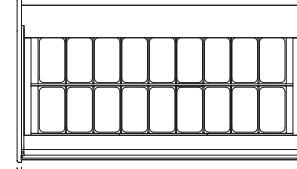

24

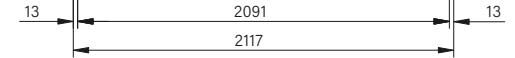
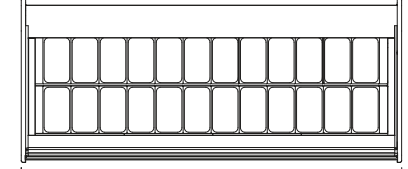

Con vaschette **LARGE**: 5,4Lt - 8 Lt - 11 Lt

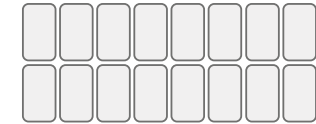
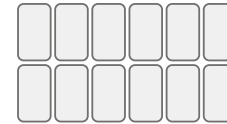
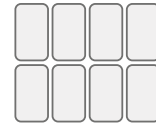

Mod.

12

18

24

DIMENSIONI / DIMENSIONS / TAILLE / GRÖSSE

Lunghezza / Length / Longueur / Länge [mm]	1092	1607	2117
Profondità / Depth / Profondeur / Tiefe [mm]	970	970	970
Altezza / Height / Hauteur / Höhe [mm]	1220/1380	1220/1380	1220/1380

PESO / WEIGHT / POIDS / GEWICHT [kg]

235/245	325/335	390/400
---------	---------	---------

IMBALLO / EMBALLAGE / PACKAGING / VERPACKUNG

Lunghezza / Length / Longueur / Länge [mm]	1220	1720	2260
Profondità / Depth / Profondeur / Tiefe [mm]	1270	1270	1270
Altezza / Height / Hauteur / Höhe [mm]	1560	1560	1560

POTENZA COMPRESSORE / POWER COMPRESSOR / PUISSANCE COMPRESSEUR / LEISTUNG VERDICHTER

(Monofase / Single-phase / Monophasé / Einphasig)

Tensione / Supply / Tension / Spannung [V/Ph/Hz]	230/1/50	230/1/50	230/1/50
Potenza assorbita / Electrical power output	1,51	2,08	2,5
Puissance absorbée / Absorbierte Leistung [kW]	1,51	2,08	2,5
Sbrinamento / In Defrost / Dégivrage / Zeitgesteuerte [kW]	2,15	3,53	3,8

(Trifase / Three-phase / Triphasé / Dreiphasig)

Tensione / Supply / Tension / Spannung [V/Ph/Hz]	400/3/50	400/3/50	400/3/50
Potenza assorbita / Electrical power output	1,3	1,97	2,8
Puissance absorbée / Absorbierte Leistung [kW]	1,3	1,97	2,8
Sbrinamento / In Defrost / Dégivrage / Zeitgesteuerte [kW]	2,52	3,87	5,1





PASTICCERIA
Pastry
Pâtisserie
Konditorei



PRALINERIA
Praline
Pralinerie
Pralinen

H=1220

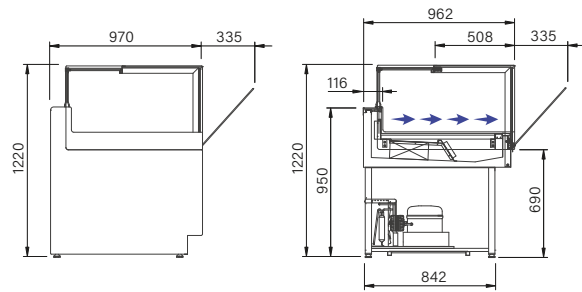

H=1380

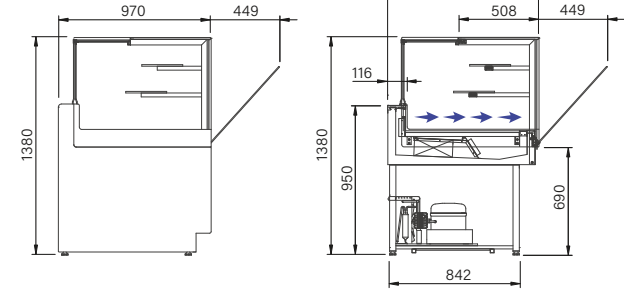

110

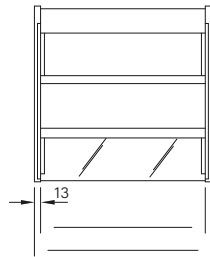

160

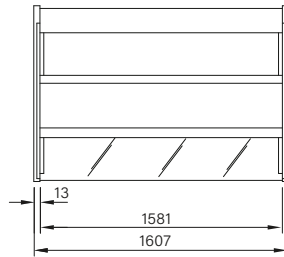

210

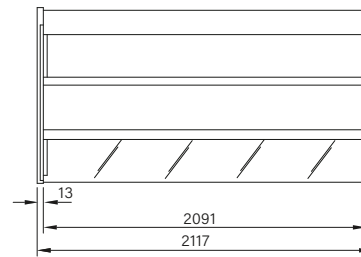

90° DX - SX

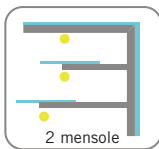
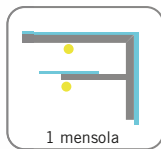
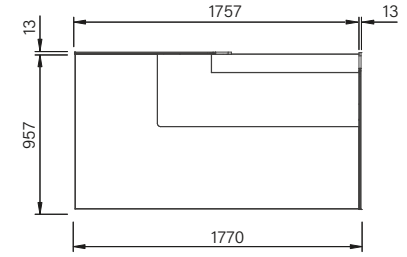

SOFT



STATIC



+2 / +4 °C



4 (30°C - 55%UR)

Mod.

110

160

210

90° DX - SX

DIMENSIONI / DIMENSIONS / TAILLE / GRÖSSE

Lunghezza / Length / Longueur / Länge [mm]	1092	1607	2117	1770
Profondità / Depth / Profondeur / Tiefe [mm]	970	970	970	970
Altezza / Height / Hauteur / Höhe [mm]	1220/1380	1220/1380	1220/1380	1220/1380

PESO / WEIGHT / POIDS / GEWICHT [kg]

110	160	210	90° DX - SX
214/224	285/302	337/353	325/335

IMBALLO / EMBALLAGE / PACKAGING / VERPACKUNG

Lunghezza / Length / Longueur / Länge [mm]	1220	1720	2260	1790
Profondità / Depth / Profondeur / Tiefe [mm]	1270	1270	1270	1200
Altezza / Height / Hauteur / Höhe [mm]	1560	1560	1560	1560

POTENZA COMPRESSORE / POWER COMPRESSOR / PUISSANCE COMPRESSEUR / LEISTUNG VERDICHTER

(Monofase / Single-phase / Monophasé / Einphasig)				
Tensione / Supply / Tension / Spannung [V/Ph/Hz]	230/1/50	230/1/50	230/1/50	230/1/50
Potenza assorbita / Electrical power output Puissance absorbée / Absorbierte Leistung [kW]	0,66	0,85	1,1	0,85
Sbrinatorio / In Defrost / Dégivrage / Zeitgesteuerte [kW]	-	-	-	-



CALDO A SECCO
Dry heat
Chaud à sec
Trockene Wärme



H=1220

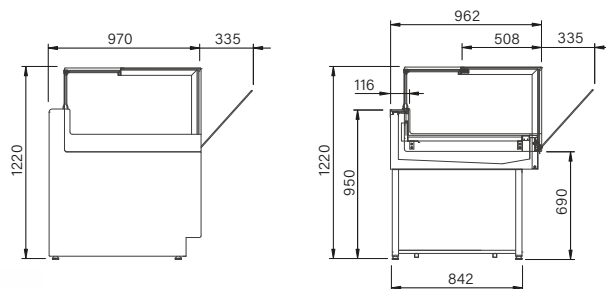

H=1380

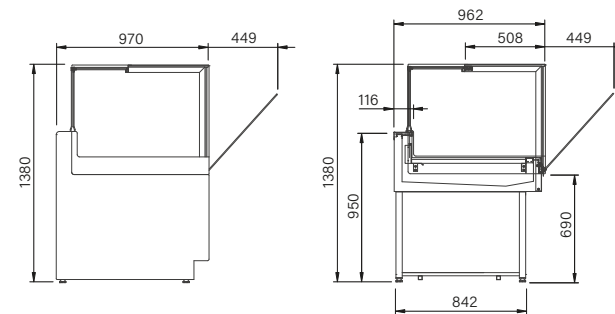

110

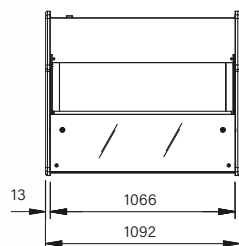

160

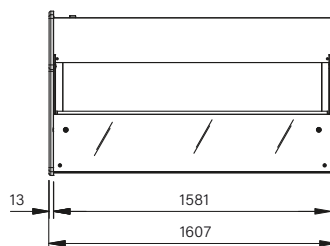

210

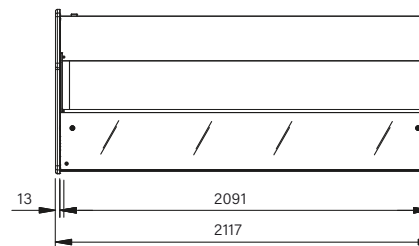

90° DX - SX

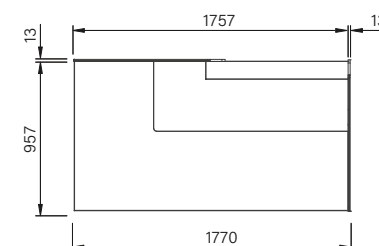

Mod.	110	160	210	90° DX - SX
DIMENSIONI / DIMENSIONS / TAILLE / GRÖSSE				
Lunghezza / Length / Longueur / Länge [mm]	1092	1607	2117	1770
Profondità / Depth / Profondeur / Tiefe [mm]	970	970	970	970
Altezza / Height / Hauteur / Höhe [mm]	1220/1380	1220/1380	1220/1380	1220/1380
PESO / WEIGHT / POIDS / GEWICHT [kg]	193/203	263/273	315/325	263/273
IMBALLO / EMBALLAGE / PACKAGING / VERPACKUNG				
Lunghezza / Length / Longueur / Länge [mm]	1220	1720	2260	1790
Profondità / Depth / Profondeur / Tiefe [mm]	1270	1270	1270	1200
Altezza / Height / Hauteur / Höhe [mm]	1560	1560	1560	1560
POTENZA COMPRESSORE / POWER COMPRESSOR / PUISSANCE COMPRESSEUR / LEISTUNG VERDICHTER				
(Monofase / Single-phase / Monophasé / Einphasig)				
Tensione / Supply / Tension / Spannung [V/Ph/Hz]	230/1/50	230/1/50	230/1/50	230/1/50
Potenza assorbita / Electrical power output	0,6	1,2	1,8	1,2
Puissance absorbée / Absorbierte Leistung [kW]	0,6	1,2	1,8	1,2
Sbrinamento / In Defrost / Dégivrage / Zeitgesteuerte [kW]	-	-	-	-



+40 / +60 °C



BAGNO MARIA
Bain marie
Bain-marie
Wasserbad

H=1220

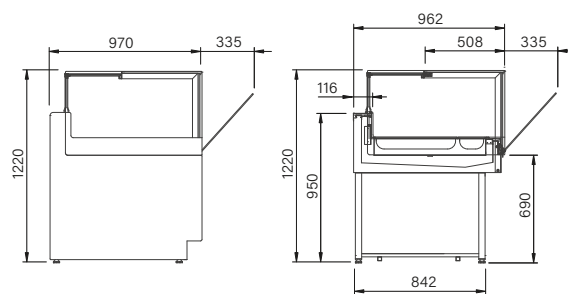

H=1380

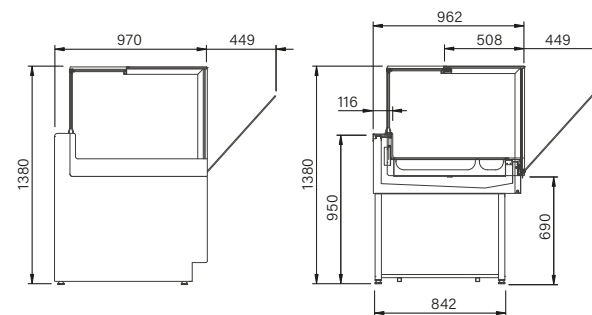

110

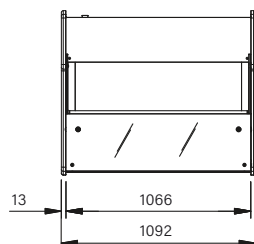

160

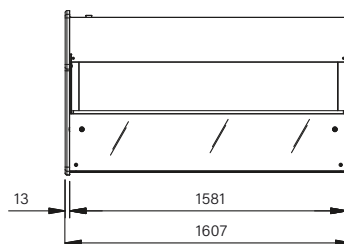

210

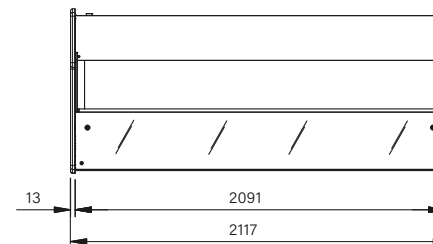

VASCHEFFE (standard)
Containers (standard)
Conteneurs (standard)
Schalen (standard)



Mod.

110

160

210

DIMENSIONI / DIMENSIONS / TAILLE / GRÖSSE

Lunghezza / Length / Longueur / Länge [mm]	1092	1607	2117
Profondità / Depth / Profondeur / Tiefe [mm]	970	970	970
Altezza / Height / Hauteur / Höhe [mm]	1220/1380	1220/1380	1220/1380

PESO / WEIGHT / POIDS / GEWICHT [kg]	193/203	263/273	315/325
---	---------	---------	---------

IMBALLO / EMBALLAGE / PACKAGING / VERPACKUNG

Lunghezza / Length / Longueur / Länge [mm]	1220	1720	2260
Profondità / Depth / Profondeur / Tiefe [mm]	1270	1270	1270
Altezza / Height / Hauteur / Höhe [mm]	1560	1560	1560

POTENZA COMPRESSORE / POWER COMPRESSOR / PUISSANCE COMPRESSEUR / LEISTUNG VERDICHTER

(Monofase / Single-phase / Monophasé / Einphasig)			
Tensione / Supply / Tension / Spannung [V/Ph/Hz]	230/1/50	230/1/50	230/1/50
Potenza assorbita / Electrical power output / Puissance absorbée / Absorbierte Leistung [kW]	1,5	2,4	3
Sbrinamento / In Defrost / Dégivrage / Zeitgesteuerte [kW]	-	-	-



+40 / +90 °C



Follow us
Italproget



ITALPROGET

Via Ponte di Ferro 85 – 06084 Bettona PG

Telefono: +39 075 987038

Fax: +39 075 987016

Email: info@italproget.it

www.italproget.it