



MAGIC



GELATO
Gelato
Gelato
Gelato



PASTICCERIA
Pastry
Pâtisserie
Konditorei



PRALINERIA
Praline
Pralinerie
Pralinen



CALDO A SECCO
Dry heat
Trockene Wärme
Chaud à sec



BAGNO MARIA
Bain marie
Wasserbad
Bain marie

Totale visibilità del prodotto da ogni lato, un design elegante, moderno e deciso, la consueta affidabile tecnologia d'avanguardia Itai Proget. MAGIC è l'ideale per gelaterie e pasticcerie anche grazie alla grande flessibilità dei suoi moduli canalizzabili.

Total product visibility from all sides and a sleek, modern, bold design. The usual reliable, cutting-edge technology we've come to expect from Itai Proget. MAGIC is ideal for ice-cream and pastry shops and delicatessens thanks in part also to the great flexibility of its ductable units.

Visibilité totale du produit sur chaque côté, design élégant, moderne et affirmé, la technologie fiable et d'avant-garde habituelle d'Itai Proget. MAGIC est le produit idéal pour les glaciers, et les pâtisseries, aussi grâce à la grande flexibilité de ses modules canalissables.

Von allen Seiten sichtbares Produkt, elegantes Design, modern und schlüssig, mit der üblichen, avantgardistischen und zuverlässigen Technologie von Itai Proget. MAGIC ist perfekt für Eisdielen, Konditoreien. Dies auch dank der Flexibilität der kanalisierbaren Baueinheiten.





GELATO
Gelato
Gelato
Gelato



DOUBLE AIR FLOW



-16 / -18 °C



7 (35°C - 75%UR)

H=1220

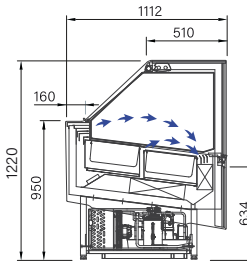
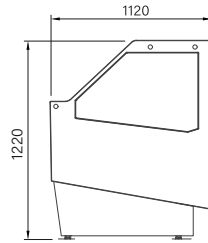

H=1380

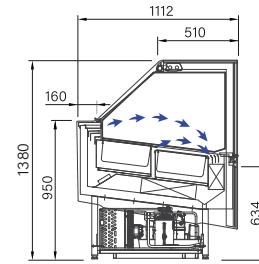
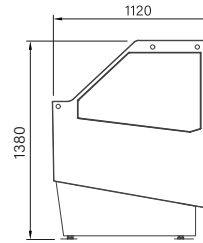

12

Con vaschette **STANDARD**: 5Lt - 7Lt

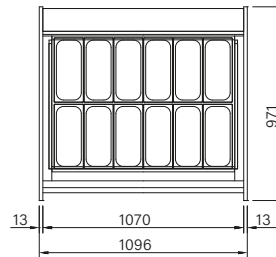

18

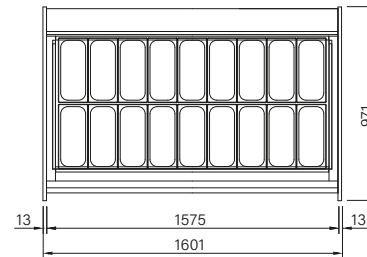

24

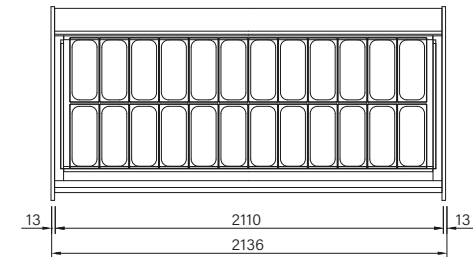

45°AP

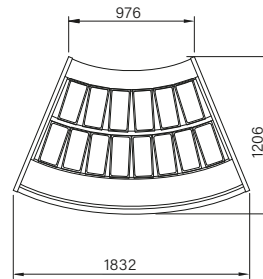

Con vaschette **LARGE**: 5,4Lt - 8Lt - 11Lt

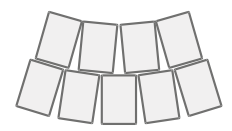
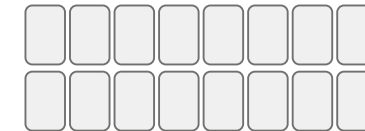
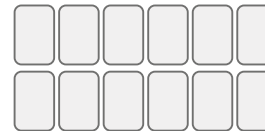
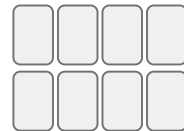

Mod.	12	18	24	45°AP
DIMENSIONI / DIMENSIONS / TAILLE / GRÖSSE				
Lunghezza / Length / Longueur / Länge [mm]	1096	1601	2136	1832
Profondità / Depth / Profondeur / Tiefe [mm]	1120	1120	1120	1120
Altezza / Height / Hauteur / Höhe [mm]	1220/1380	1220/1380	1220/1380	1220/1380
PESO / WEIGHT / POIDS / GEWICHT [kg]	235/245	325/335	390/400	325/335
IMBALLO / EMBALLAGE / PACKAGING / VERPACKUNG				
Lunghezza / Length / Longueur / Länge [mm]	1220	1720	2260	2050
Profondità / Depth / Profondeur / Tiefe [mm]	1270	1270	1270	1390
Altezza / Height / Hauteur / Höhe [mm]	1560	1560	1560	1560
POTENZA COMPRESSORE / POWER COMPRESSOR / PUISSANCE COMPRESSEUR / LEISTUNG VERDICHTER				
(Monofase / Single-phase / Monophasé / Einphasig)				
Tensione / Supply / Tension / Spannung [V/Ph/Hz]	230/1/50	230/1/50	230/1/50	230/1/50
Potenza assorbita / Electrical power output				
Puissance absorbée / Absorbierte Leistung [kW]	1,51	2,08	2,5	2,08
Sbrinamento / In Defrost / Dégivrage / Zeitgesteuerte [kW]	2,15	3,53	3,8	3,53
(Trifase / Three-phase / Triphasé / Dreiphasig)				
Tensione / Supply / Tension / Spannung [V/Ph/Hz]	400/3/50	400/3/50	400/3/50	400/3/50
Potenza assorbita / Electrical power output				
Puissance absorbée / Absorbierte Leistung [kW]	1,3	1,97	2,8	1,97
Sbrinamento / In Defrost / Dégivrage / Zeitgesteuerte [kW]	2,52	3,87	5,1	3,87



PASTICCERIA
Pastry
Pâtisserie
Konditorei



PRALINERIA
Praline
Pralinerie
Pralinen

H=1220

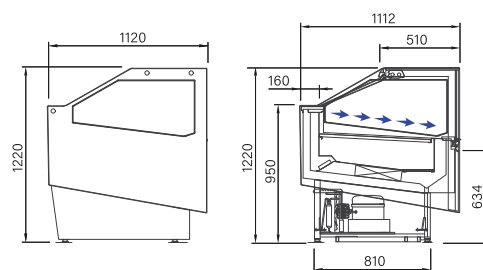

H=1380

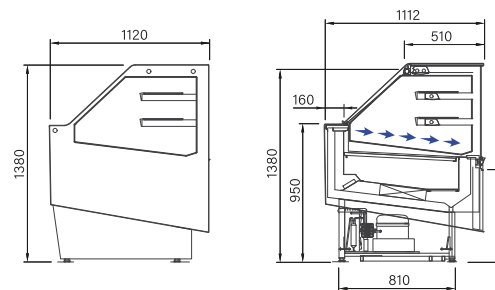

110

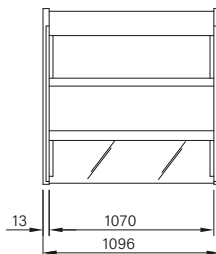

160

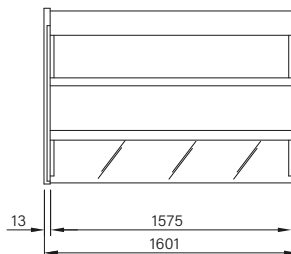

210

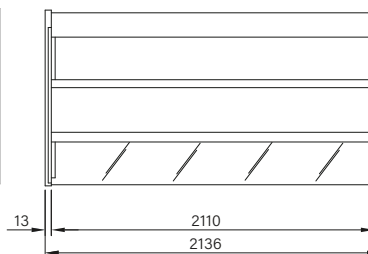

45°AP

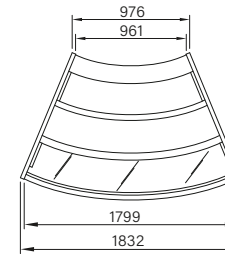

45°CH

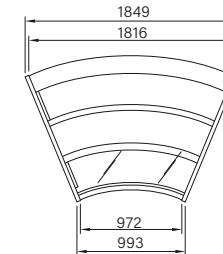

Mod.	110	160	210	45°AP	45°CH
DIMENSIONI / DIMENSIONS / TAILLE / GRÖSSE					
Lunghezza / Length / Longueur / Länge [mm]	1096	1601	2136	1832	1849
Profondità / Depth / Profondeur / Tiefe [mm]	1120	1120	1120	1120	1120
Altezza / Height / Hauteur / Höhe [mm]	1220/1380	1220/1380	1220/1380	1220/1380	1220/1380
PESO / WEIGHT / POIDS / GEWICHT [kg]	214/224	285/295	337/347	304/314	304/314
IMBALLO / EMBALLAGE / PACKAGING / VERPACKUNG					
Lunghezza / Length / Longueur / Länge [mm]	1220	1720	2260	2050	2050
Profondità / Depth / Profondeur / Tiefe [mm]	1270	1270	1270	1390	1390
Altezza / Height / Hauteur / Höhe [mm]	1560	1560	1560	1560	1560
POTENZA COMPRESSORE / POWER COMPRESSOR / PUISSANCE COMPRESSEUR / LEISTUNG VERDICHTER					
(Monofase / Single-phase / Monophasé / Einphasig)					
Tensione / Supply / Tension / Spannung [V/Ph/Hz]	230/1/50	230/1/50	230/1/50	230/1/50	230/1/50
Potenza assorbita / Electrical power output Puissance absorbée / Absorbierte Leistung [kW]	0,66	0,85	1,1	0,66	0,66
Sbrinatorio / In Defrost / Dégivrage / Zeitgesteuerte [kW]	-	-	-	-	-



5 SOFT



+2 / +4 °C



4 (30°C - 55%UR)



CALDO A SECCO
Dry heat
Trockene Wärme
Chaud à sec



H=1220

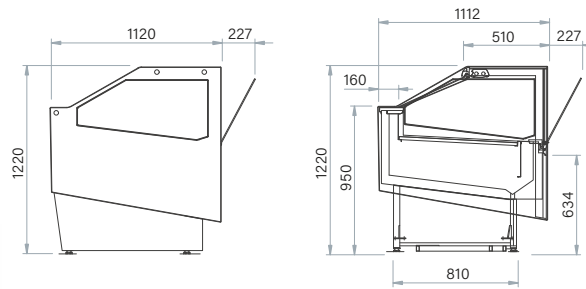

H=1380

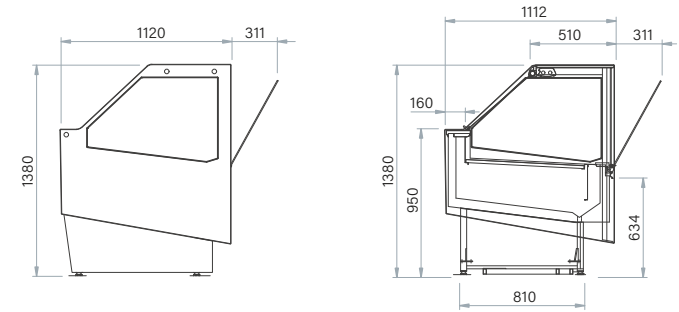

110

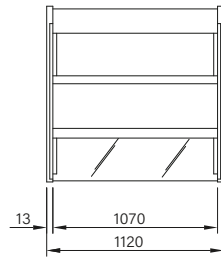

160

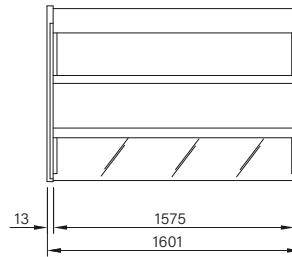

210

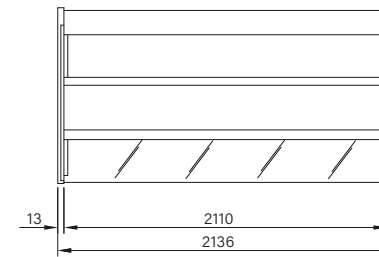

+40 / +60 °C

Mod.	110	160	210
DIMENSIONI / DIMENSIONS / TAILLE / GRÖSSE			
Lunghezza / Length / Longueur / Länge [mm]	1120	1601	2136
Profondità / Depth / Profondeur / Tiefe [mm]	1120	1120	1120
Altezza / Height / Hauteur / Höhe [mm]	1220/1380	1220/1380	1220/1380
PESO / WEIGHT / POIDS / GEWICHT [kg]	193/203	263/273	315/325
IMBALLO / EMBALLAGE / PACKAGING / VERPACKUNG			
Lunghezza / Length / Longueur / Länge [mm]	1220	1720	2260
Profondità / Depth / Profondeur / Tiefe [mm]	1240	1240	1240
Altezza / Height / Hauteur / Höhe [mm]	1560	1560	1560
POTENZA COMPRESSORE / POWER COMPRESSOR / PUISSANCE COMPRESSEUR / LEISTUNG VERDICHTER			
(Monofase / Single-phase / Monophasé / Einphasig)			
Tensione / Supply / Tension / Spannung [V/Ph/Hz]	230/1/50	230/1/50	230/1/50
Potenza assorbita / Electrical power output Puissance absorbée / Absorbierte Leistung [kW]	0,60	1,2	1,8
Sbrinamento / In Defrost / Dégivrage / Zeitgesteuerte [kW]	-	-	-



BAGNO MARIA
Bain marie
Wasserbad
Bain marie

H=1220

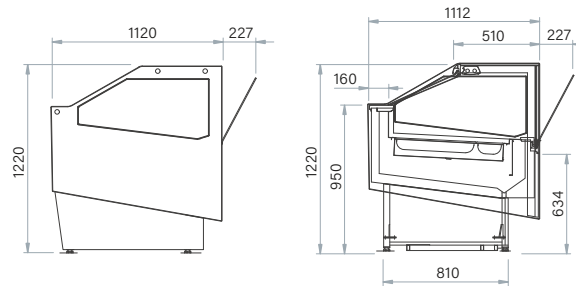

H=1380

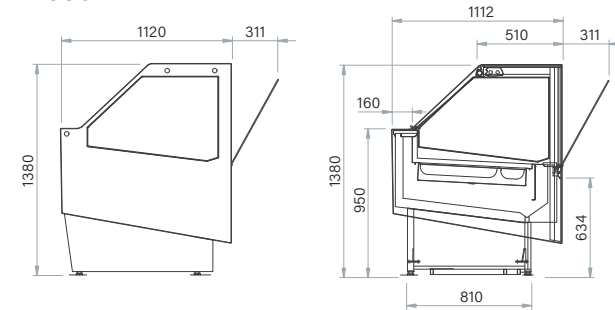

110

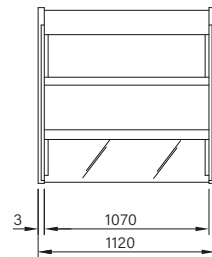

160

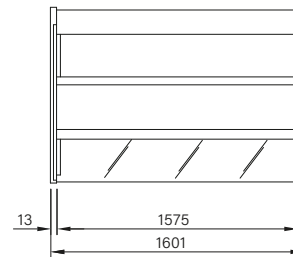

210

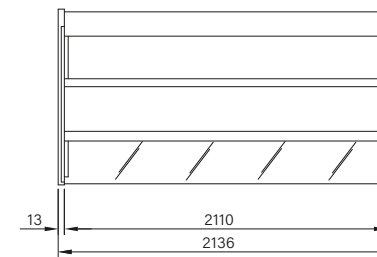

VASCHETTE (standard)
Containers (standard)
Conteneurs (standard)
Schalen (standard)

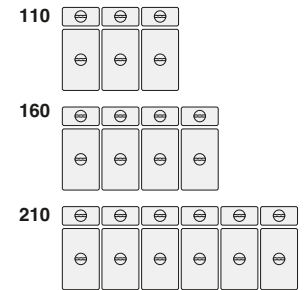

Mod.	110	160	210
DIMENSIONI / DIMENSIONS / TAILLE / GRÖSSE			
Lunghezza / Length / Longueur / Länge [mm]	1120	1601	2136
Profondità / Depth / Profondeur / Tiefe [mm]	1120	1120	1120
Altezza / Height / Hauteur / Höhe [mm]	1220/1380	1220/1380	1220/1380
PESO / WEIGHT / POIDS / GEWICHT [kg]	193/203	263/273	315/325
IMBALLO / EMBALLAGE / PACKAGING / VERPACKUNG			
Lunghezza / Length / Longueur / Länge [mm]	1220	1720	2260
Profondità / Depth / Profondeur / Tiefe [mm]	1240	1240	1240
Altezza / Height / Hauteur / Höhe [mm]	1560	1560	1560
POTENZA COMPRESSORE / POWER COMPRESSOR / PUISSANCE COMPRESSEUR / LEISTUNG VERDICHTER			
(Monofase / Single-phase / Monophasé / Einphasig)			
Tensione / Supply / Tension / Spannung [V/Ph/Hz]	230/1/50	230/1/50	230/1/50
Potenza assorbita / Electrical power output	1,5	2,4	3
Puissance absorbée / Absorbierte Leistung [kW]	-	-	-
Sbrinamento / In Defrost / Dégivrage / Zeitgesteuerte [kW]	-	-	-



+40 / +90 °C



Follow us
Italproget



ITALPROGET

Via Ponte di Ferro 85 – 06084 Bettona PG

Telefono: +39 075 987038

Fax: +39 075 987016

Email: info@italproget.it

www.italproget.it