



TWIST



GELATO
Gelato
Gelato
Gelato



PASTICCERIA
Pastry
Pâtisserie
Konditorei



PRALINERIA
Praline
Pralinerie
Prälinen



CALDO A SECCO
Dry Heat
Chaud A Sec
Trockene Wärme



BAGNO MARIA
Bain marie
Bain marie
Wasserbad

Modello di vetrina dalla vasta gamma di servizi: dal gelato alla pasticceria, pralineria e gastronomia.
Il design della TWIST rappresenta il carattere giovane e dinamico di Ital Proget.

Display case model offering a wide range of services: from ice-cream to pastries, candies to delicatessens.
TWIST design represents the young, dynamic character of Ital Proget.

Modèle de vitrine permettant une vaste gamme de services : de la glace à la pâtisserie, des chocolats à la gastronomie.
Le design de TWIST représente le caractère jeune et dynamique d'Ital Proget.

Die vielseitige Vitrine mit verschiedenen Einsatzmöglichkeiten: geeignet für Eisdielen, Konditorei, Konfiserie und Gastronomie.
Das Design von TWIST verkörpert den jungen und dynamischen Geist von Ital Proget.







GELATO
Gelato
Gelato
Gelato



H=1380

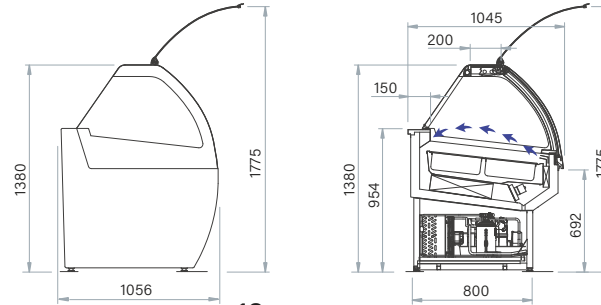

12

Con vaschette **STANDARD**: 5Lt

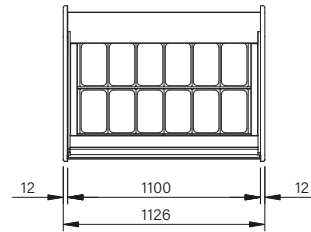

18

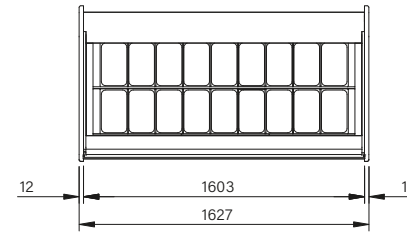

24

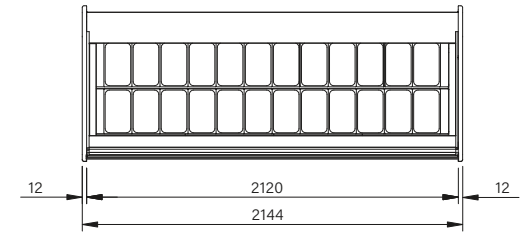

Con vaschette **LARGE**: 5,4Lt - 8 Lt

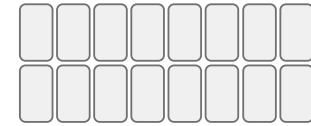
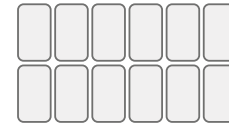
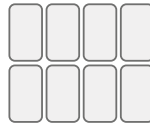

Mod.

12

18

24

DIMENSIONI / DIMENSIONS / TAILLE / GRÖSSE

Lunghezza / Length / Longueur / Länge [mm]	1124	1627	2144
Profondità / Depth / Profondeur / Tiefe [mm]	1056	1056	1056
Altezza / Height / Hauteur / Höhe [mm]	1380	1380	1380

PESO / WEIGHT / POIDS / GEWICHT [kg]	230	315	380
---	-----	-----	-----

IMBALLO / EMBALLAGE / PACKAGING / VERPACKUNG

Lunghezza / Length / Longueur / Länge [mm]	1220	1720	2260
Profondità / Depth / Profondeur / Tiefe [mm]	1270	1270	1270
Altezza / Height / Hauteur / Höhe [mm]	1560	1560	1560

POTENZA COMPRESSORE / POWER COMPRESSOR / PUISSANCE COMPRESSEUR / LEISTUNG VERDICHTER

(Monofase / Single-phase / Monophasé / Einphasig)

Tensione / Supply / Tension / Spannung [V/Ph/Hz]	230/1/50	230/1/50	230/1/50
Potenza assorbita / Electrical power output	1,51	2,08	2,5
Puissance absorbée / Absorbierte Leistung [kW]	1,51	2,08	2,5
Sbrinamento / In Defrost / Dégivrage / Zeitgesteuerte [kW]	2,15	3,53	3,8

(Trifase / Three-phase / Triphasé / Dreiphasig)

Tensione / Supply / Tension / Spannung [V/Ph/Hz]	400/3/50	400/3/50	400/3/50
Potenza assorbita / Electrical power output	1,3	1,97	2,8
Puissance absorbée / Absorbierte Leistung [kW]	1,3	1,97	2,8
Sbrinamento / In Defrost / Dégivrage / Zeitgesteuerte [kW]	2,52	3,87	5,1



SINGLE AIR FLOW



-16 / -18 °C



7 (35°C - 75%UR)



GAS R290



PASTICCERIA
Pastry
Pâtisserie
Konditorei



PRALINERIA
Praline
Pralinerie
Pralinen



H=1380

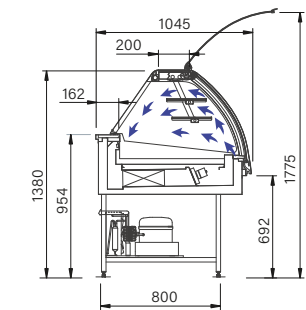
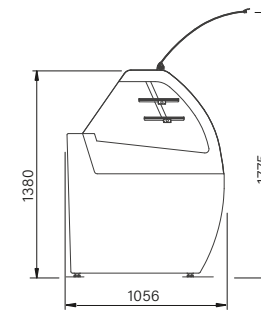
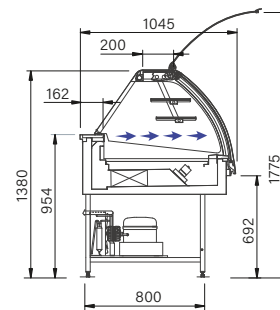
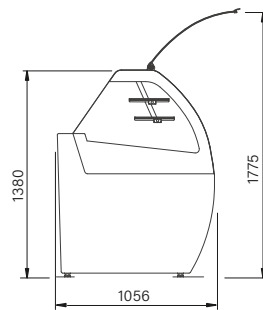

110

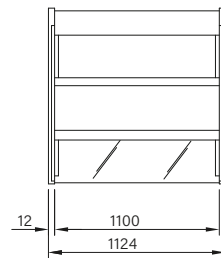

160

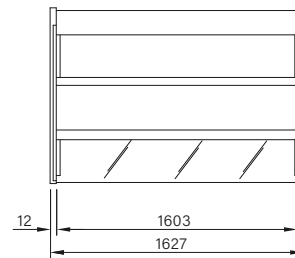

210

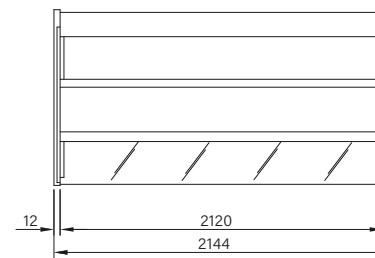

Mod.

110

160

210

DIMENSIONI / DIMENSIONS / TAILLE / GRÖSSE

Lunghezza / Length / Longueur / Länge [mm]	1124	1627	2144
Profondità / Depth / Profondeur / Tiefe [mm]	1056	1056	1056
Altezza / Height / Hauteur / Höhe [mm]	1380	1380	1380

PESO / WEIGHT / POIDS / GEWICHT [kg]	224	302	328
---	-----	-----	-----

IMBALLO / EMBALLAGE / PACKAGING / VERPACKUNG

Lunghezza / Length / Longueur / Länge [mm]	1220	1720	2260
Profondità / Depth / Profondeur / Tiefe [mm]	1270	1270	1270
Altezza / Height / Hauteur / Höhe [mm]	1560	1560	1560

POTENZA COMPRESSORE / POWER COMPRESSOR / PUISSANCE COMPRESSEUR / LEISTUNG VERDICHTER

(Monofase / Single-phase / Monophasé / Einphasig)			
Tensione / Supply / Tension / Spannung [V/Ph/Hz]	230/1/50	230/1/50	230/1/50
Potenza assorbita / Electrical power output			
Puissance absorbée / Absorbierte Leistung [kW]	0,66 / 1,8	0,85 / 1,32	1,1 / 1,48
Sbrinatorio / In Defrost / Dégivrage / Zeitgesteuerte [kW]	-	-	-



SOFT



FULL



+2 / +4 °C



4 (30°C - 55%UR)



CALDO A SECCO
Dry heat
Chaud à sec
Trockene Wärme



H=1380

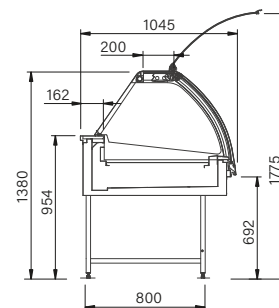
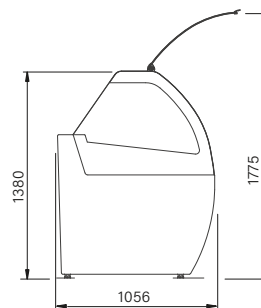

110

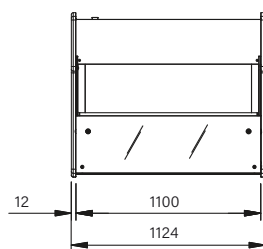

160

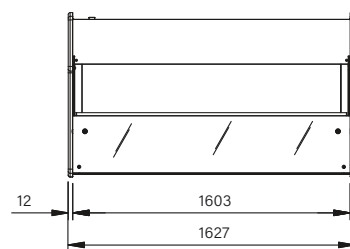

210

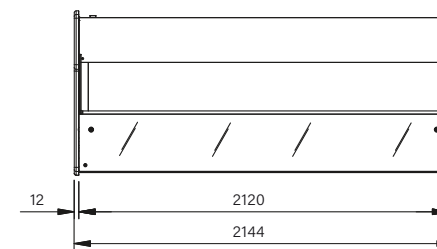

Mod.	110	160	210
DIMENSIONI / DIMENSIONS / TAILLE / GRÖSSE			
Lunghezza / Length / Longueur / Länge [mm]	1124	1627	2144
Profondità / Depth / Profondeur / Tiefe [mm]	1056	1056	1056
Altezza / Height / Hauteur / Höhe [mm]	1380	1380	1380
PESO / WEIGHT / POIDS / GEWICHT [kg]			
	203	280	325
IMBALLO / EMBALLAGE / PACKAGING / VERPACKUNG			
Lunghezza / Length / Longueur / Länge [mm]	1220	1720	2260
Profondità / Depth / Profondeur / Tiefe [mm]	1270	1270	1270
Altezza / Height / Hauteur / Höhe [mm]	1560	1560	1560
POTENZA COMPRESSORE / POWER COMPRESSOR / PUISSANCE COMPRESSEUR / LEISTUNG VERDICHTER			
(Monofase / Single-phase / Monophasé / Einphasig)			
Tensione / Supply / Tension / Spannung [V/Ph/Hz]	230/1/50	230/1/50	230/1/50
Potenza assorbita / Electrical power output	0,6	1,2	1,8
Puissance absorbée / Absorbierte Leistung [kW]	0,6	1,2	1,8
Sbrinamento / In Defrost / Dégivrage / Zeitgesteuerte [kW]	-	-	-



+40 / +60 °C



BAGNO MARIA
Bain marie
Bain-marie
Wasserbad



H=1380

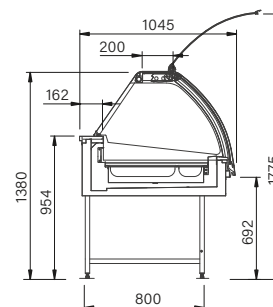
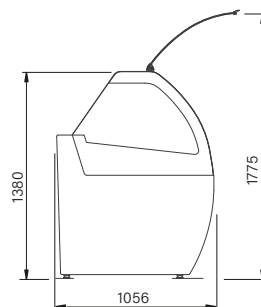

110

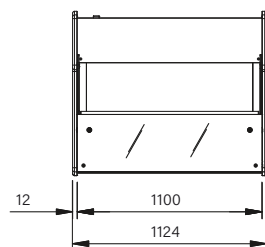

160

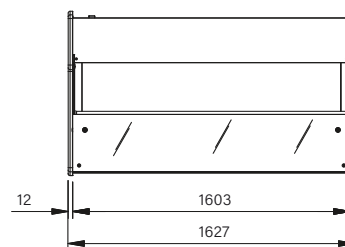

210

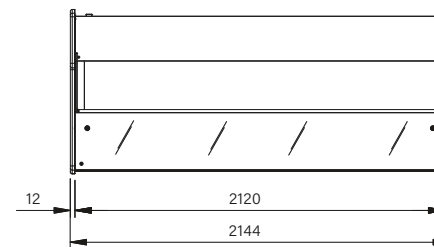

Mod.

110

160

210

DIMENSIONI / DIMENSIONS / TAILLE / GRÖSSE

Lunghezza / Length / Longueur / Länge [mm]	1124	1627	2144
Profondità / Depth / Profondeur / Tiefe [mm]	1056	1056	1056
Altezza / Height / Hauteur / Höhe [mm]	1328	1328	1328

PESO / WEIGHT / POIDS / GEWICHT [kg]

203	280	325
-----	-----	-----

IMBALLO / EMBALLAGE / PACKAGING / VERPACKUNG

Lunghezza / Length / Longueur / Länge [mm]	1220	1720	2260
Profondità / Depth / Profondeur / Tiefe [mm]	1270	1270	1270
Altezza / Height / Hauteur / Höhe [mm]	1560	1560	1560

POTENZA COMPRESSORE / POWER COMPRESSOR / PUISSANCE COMPRESSEUR / LEISTUNG VERDICHTER

(Monofase / Single-phase / Monophasé / Einphasig)			
Tensione / Supply / Tension / Spannung [V/Ph/Hz]	230/1/50	230/1/50	230/1/50
Potenza assorbita / Electrical power output			
Puissance absorbée / Absorbierte Leistung [kW]	1,5	2,4	3
Sbrinatorio / In Defrost / Dégivrage / Zeitgesteuerte [kW]	-	-	-

VASCHETTE (standard)
Containers (standard)
Conteneurs (standard)
Schalen (standard)

110



160



210



+40 / +90 °C



Follow us
Italproget



ITALPROGET

Via Ponte di Ferro 85 – 06084 Bettona PG

Telefono: +39 075 987038

Fax: +39 075 987016

Email: info@italproget.it

www.italproget.it